

# **THERMAL DYNAMICS** *Professional*

# **1Torch**<sup>®</sup>

with **SURELOK**<sup>®</sup> Technology



**One Torch  
for Virtually Any  
Plasma Cutting  
System!**

Take the **TD** Challenge

**30 Days, 100% Satisfaction  
or Your Money Back,  
Guaranteed!**

Call 1-800-752-7621 for details.

[www.thermal-dynamics.com](http://www.thermal-dynamics.com)

Available With Our **ATC**<sup>®</sup>  
Quick Change Connector!



*The Revolution in Plasma Torches Has Begun*

**THERMAL DYNAMICS**  
Professional

# 1Torch®

with **SURELOK®** Technology



## The First Universal Plasma Torch!

The 1Torch® RPT® torch is the first plasma cutting torch that performs with virtually all plasma cutting power supplies. The 1Torch works with high frequency start systems, CD start systems, touch start systems and moving parts (blow back) start systems. Install the 1Torch on your current plasma power supply and you immediately benefit from the latest in high performance torch technology available today.

## Important Features Include:

### Ergonomic Torch Handle

With an innovative, easy-to-use torch trigger release, encapsulated protected torch head and precisely engineered grip, the 1Torch RPT torch is both easy and comfortable to use.



### Extended or Protected Consumable Parts

We designed our consumable parts to adapt to your cutting style. By simply changing the shield cup, you can either have:

- An Extended Tip for greater visibility and control and precision drag cutting at low power.
- A Protected Tip for on-the-plate drag cutting at high power up to 100 amps.

### One Year Torch & Leads Warranty

### Precision Engineered Torch Consumable Parts

The 1Torch RPT torch introduces a completely new tip technology. Plasma gas management is an integral part of the tip design. Each tip is uniquely tuned to optimize cut performance at its rated cutting current. The result is precision gas management, longer consumable parts life and better cut performance across the entire range of 1Torch tips.

### Lower Consumable Parts Inventories and Costs

The less than 25 consumable parts used with the 1Torch RPT torch can replace over 575 different consumable parts used over a broad range of plasma systems.

### Improved Leads

1Torch Leads are lightweight, extremely flexible and tough – the ideal combination of durability and ease of use.

### ATC® (Advanced Torch Connector) Quick Disconnect Option

Our quick disconnect design brings extra flexibility to any plasma system.

Imagine being able to change out a damaged plasma cutting torch, easily convert from a hand to a machine torch operation, or simply put on a different size torch all in the matter of a few seconds and not have to use any tools to complete the task!



### ATC Lead Extensions for Improved Versatility

You can add substantial flexibility and versatility to your cutting operations with the use of Lead Extensions. Quick Disconnect Lead Extensions, in 15 ft., 25 ft. and 50 ft. lengths, make it easy and efficient to add or subtract lead length according to the job requirements.

*1Torch RPT torch and ATC connector are patent pending.*

# 1Torch®

with SURELOK® Technology

**One Torch for Virtually Any Plasma Cutting System!**

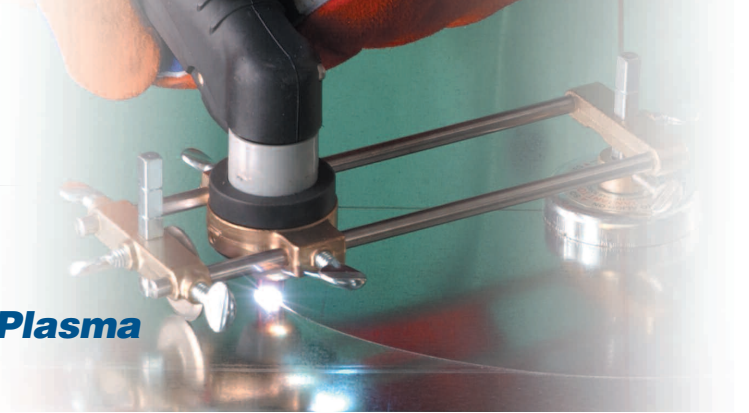

## Selecting the Right Torch Package for Your Needs . . .

It's as easy as 1, 2, 3!

### 1 Torch and Leads Selection

Chart 1 (pg. 4) gives you all the information you'll need to select the right torch. Torches are grouped into two sections – SL60® and SL100® Hand Torches. Find the appropriate section, decide whether the standard RPT® connection or the ATC® Torch Connection is right for you, then select the torch with the desired amperage range and leads length.

### 2 Adapter Kit Selection

Select the appropriate Adapter Kit from Chart 2 (pg. 5). If you selected a torch with the ATC Connection, you will also need an ATC Receptacle Adapter (see Chart 1).

### 3 Spare Parts Selection

From Chart 3 (pg. 6), select an RPT Spare Parts Kit or specific consumable parts that best suit your cutting requirements.

## Torch Connection Options

The diagram below shows the differences between the Standard RPT and the ATC Torch connections.

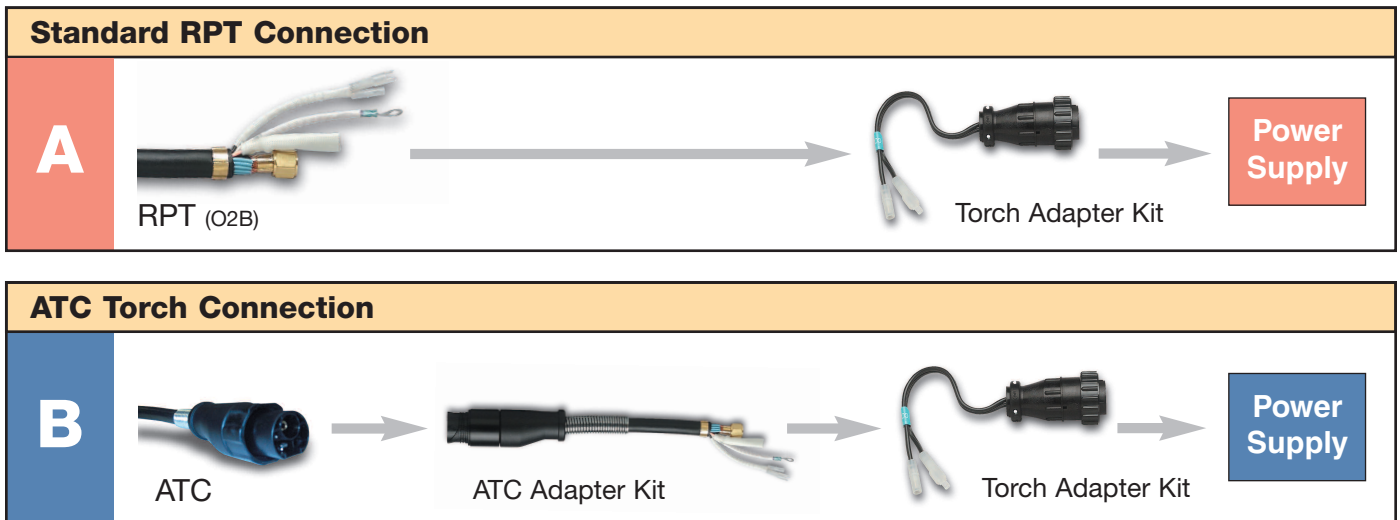



## Torch and Lead Selection



Listed below are the Torch and Lead selection charts for the SL60<sup>®</sup> and SL100<sup>®</sup> Hand 1Torch RPT<sup>®</sup> torches.

### Ordering Information

#### Hand Torches

##### SL60

Light/Medium Duty Torch  
20-60 Amps



##### SL100

Medium/Heavy Duty Torch  
30-100 Amps



CAT NO. DESCRIPTION

#### A Standard RPT (O2B) Torch Connection



##### Torch & Leads

###### SL60 Hand Torch (20-60 Amps)

|        |                                    |
|--------|------------------------------------|
| 7-5200 | SL60, 75°, 20' (6.1m) Torch/Leads  |
| 7-5201 | SL60, 75°, 50' (15.2m) Torch/Leads |

#### B ATC<sup>®</sup> Torch Connection



##### Torch & Leads

###### SL60 Hand Torch w/ ATC (20-60 Amps)

|        |                                     |
|--------|-------------------------------------|
| 7-5204 | *SL60, 75°, 20' (6.1m) Torch/Leads  |
| 7-5205 | *SL60, 75°, 50' (15.2m) Torch/Leads |

##### ATC Adapter Kit

###### ATC Receptacle Adapter

|        |                          |
|--------|--------------------------|
| 7-5207 | ATC Receptacle Connector |
|--------|--------------------------|

\* This receptacle adapter is required for each power supply using an ATC torch connection. This is connected to the torch adapter kit specific to each power supply.



##### ATC Lead Extensions

###### Lead Extensions - Standard

|        |                            |
|--------|----------------------------|
| 7-7544 | 15' (4.5m) Lead Extension  |
| 7-7545 | 25' (7.6m) Lead Extension  |
| 7-7552 | 50' (15.2m) Lead Extension |

CAT NO. DESCRIPTION

#### A Standard RPT (O2B) Torch Connection



##### Torch & Leads

###### SL100 Hand Torch (30-100 Amps)

|        |                                     |
|--------|-------------------------------------|
| 7-5202 | SL100, 75°, 20' (6.1m) Torch/Leads  |
| 7-5203 | SL100, 75°, 50' (15.2m) Torch/Leads |

#### B ATC Torch Connection



##### Torch & Leads

###### SL100 Hand Torch w/ ATC (30-100 Amps)

|        |                                      |
|--------|--------------------------------------|
| 7-5206 | *SL100, 75°, 20' (6.1m) Torch/Leads  |
| 7-5208 | *SL100, 75°, 50' (15.2m) Torch/Leads |

##### ATC Adapter Kit

###### ATC Receptacle Adapter

|        |                          |
|--------|--------------------------|
| 7-5207 | ATC Receptacle Connector |
|--------|--------------------------|

\* This receptacle adapter is required for each power supply using an ATC torch connection. This is connected to the torch adapter kit specific to each power supply.



##### ATC Lead Extensions

###### Lead Extensions - Standard

|        |                            |
|--------|----------------------------|
| 7-7544 | 15' (4.5m) Lead Extension  |
| 7-7545 | 25' (7.6m) Lead Extension  |
| 7-7552 | 50' (15.2m) Lead Extension |

NOTES: \*Total lead length including torch and extension(s), should not exceed the maximum length specified by the power supply manufacturer.

# 1Torch®

with **SURELOK®** Technology

## Adapter Kit Selection

Listed below is the Adapter Kit selection charts for the Hand 1Torch RPT torch.



### Torch Adapter Kits

The model of the plasma cutting system must be known to determine the adapter kit required.

| Manufacturer<br>Power Supply Model       | Catalog<br>Number | Manufacturer<br>Power Supply Model                         | Catalog<br>Number       |
|--|-------------------|--|-------------------------|
| <b>AIRCO®/BOC®</b>                       |                   | <b>LINCOLN®</b>  |                         |
| PCS-43                                   | 7-3425            | Pro-Cut® 40  | 7-3486                  |
| PCS-53, PCS-80, PCS-90                   | 7-3435            | Pro-Cut® 55  | see 63-2530 for details |
| <b>CEBORA®</b>                           |                   | Pro-Cut® 60  | 7-3431                  |
| 50                                       | 7-3438            | Pro-Cut® 80  | see 63-2530 for details |
| Pocket 25                                | 7-3476            | <b>MARQUETTE®</b>  |                         |
| <b>CENTURY®</b>                          |                   | 12/150, 12/200   | 7-3476                  |
| 82020*, 82050*, M2050*                   | 7-3476            | <b>MATCO®</b>  |                         |
| 82100                                    | 7-3430            | 2020*, 2050*   | 7-3476                  |
| <b>DAIHEN®</b>                           |                   | <b>MILLER®</b>   |                         |
| SC-60P                                   | 7-3432            | Plazcut 60†/Zipcut   | 7-3432                  |
| MRAT-70                                  | 7-3437            | Spectrum® 250D, 500, 750                                   | 7-3433                  |
| <b>DAYTON®</b>                           |                   | Spectrum® 700, 1000, 1250, PLUS                            | 7-3430                  |
| 3W722A*, 5Z031B*                         | 7-3476            | Spectrum® 3080*  | 7-3456                  |
| <b>ESAB®</b> (yellow)                    |                   | Spectrum® 650*, 701*, 2050*                                | 7-3457                  |
| PCM-SMi, 500i, 625i, PCS-43              | 7-3425            | Spectrum® 300*   | 7-3476                  |
| PCS-53, 80, 90                           | 7-3435            | Spectrum® 375*   | 7-3477                  |
| ESP-100i                                 | 7-3426            | Spectrum® 625*   | 7-3478                  |
| PCM-750i, 875, 1000i, 1125               | 7-3429            | <b>MULTIQUIP MQ®</b>                                       |                         |
| Sidewinder 30, 55, 105                   | 7-3434            | PCX50SS  | 7-3437                  |
| Powercut® 650                            | 7-3464            | <b>NU-TECSYS®</b>  |                         |
| Powercut® 875, 1125                      | 7-3465            | Omnicut 375  | 7-3438                  |
| Powercut® 1250, 1500                     | 7-3462            | PCA-30/60, 65  | 7-3441                  |
| <b>HARRIS®</b>                           |                   | <b>OTC</b>   |                         |
| System 50, 65, 100                       | 7-3439            | Panasonic® D-5000, D-7000                                  | 7-3437                  |
| <b>HOBART®</b>                           |                   | <b>P-TRON®</b>   |                         |
| Smoothcut 30, 625                        | 7-3425            | P-Tron 75, 100   | 7-3437                  |
| Smoothcut 50 (single gas), 100           | 7-3426            | <b>POWCON®</b>   |                         |
| Smoothcut 50 (dual gas)                  | 7-3428            | Starcut  | 7-3430                  |
| Smoothcut II 35A, 60A, 100A              | 7-3427            | <b>SMITH®</b>  |                         |
| Fab Shop                                 | 7-3440            | Powerpro 55, 75  | 7-3487                  |
| Cybercut 2050*                           | 7-3457            | SPC-30, 20-50, 40-80                                       | 7-3442                  |
| <b>HYPERTHERM®</b>                       |                   | <b>SNAP-ON®</b>  |                         |
| Max® 40, HT® 40 (H/F Start)              | 7-3430            | YA-3230, YA-3440   | 7-3430                  |
| Max® 70, Max® 80, Max® 100 w/ & w/o Q.D. |                   | YA-2230*, YA-5550*, YA-5550A*                              | 7-3476                  |
| Max® 42*, 43*, 40cs*                     | 7-3454            | <b>SOLAR®</b>  |                         |
| powermax® 600*, 800*, 900* w/ Q.D.       |                   | SOL 2020* (118-009, 118-010), SOL 2050* (118-015, 118-016) | 7-3476                  |
| powermax® 1100*                          | 7-3455            | SOL 2105, SOL 2106   | 7-3430                  |
| powermax® 1000*, 1250*                   | 7-3461            | <b>THERMAL DYNAMICS®</b>                                   |                         |
| Max® 40cs* (w/o Q.D.)                    | 7-3476            | PAK® 3XR, 5XT, 5XR, 6XR, 7XR, 625XR, 750XR                 | 7-3446                  |
| powermax® 380*                           | 7-3477            | PAK® 8XR, 10XR, 1000XR, 1250XR,                            | 7-3434                  |
| powermax® 600* w/o Q.D.                  | 7-3480            | PakMaster® 75, 100   |                         |
| powermax® 800*, 900* w/o Q.D.            | 7-3481            | PakMaster® 50XL/XLP, 75XL/XLP, 100XL/XLP                   | 7-3447                  |
| powermax® 1650*                          | 7-3483            | CUTMASTER® 50, 75, 80XL, 100                               |                         |
| powermax® 350*                           | 7-3484            | PakMaster® 25, 38XL, EconoPAK® 25                          | 7-3443                  |
| powermax® 190C*                          | 7-3485            | Drag-Gun® 38, PAK® 4Xi, 6Xi                                |                         |
| <b>L TEC®</b> (green)                    |                   | PAK® 2XT, Dynapak® 110                                     |                         |
| PCM-31, SMi, 32i/34i, VPi                | 7-3425            | PakMaster® 50 w/ Smart Torch (Q.D.)                        | 7-3445                  |
| PCM-500i, 625i, PCS-80i                  |                   | EconoPAK® 50   | 7-3449                  |
| PCM-50A, 70, 80, 52i/54i, 82i/84i        | 7-3426            | EconoPAK® 100  | 7-3450                  |
| ESP-100i, PCM-50, PCM-100 (Single Gas)   |                   | PAK® 5   | 7-3444                  |
| PCM-50, PCM-100 (Dual Gas)               |                   | PAK® 10  | 7-3436                  |
| PCS-40                                   | 7-3430            |  |                         |
| PCM-750i, 1000i                          | 7-3435            |  |                         |
| PCM-101                                  | 7-3436            |  |                         |

\*Non-HF Systems.

†The Miller PlazCut machines with Serial Numbers beginning JE are not compatible with 1Torch® RPT Torches.

NOTES: Each Adapter Kit includes connection fitting, electrical connectors and installation instruction sheets for the selected power supply.

AIRCO/BOC are registered trademarks of The BOC Group plc; CEBORA is a registered trademark of Cebora S.p.A.; DAIHEN is a registered trademark of Daihen Inc.; ESAB, L-TEC and Power-Cut are registered trademarks of ESAB AB; HARRIS, LINCOLN and Pro-Cut are registered trademarks of Lincoln Electric Co.; HOBART is a registered trademark of Hobart Brothers Co.; HYPERTHERM, Max and powermax are registered trademarks of Hypertherm, Inc.; MILLER and Spectrum are registered trademarks of Miller Electric Mfg. Co.; MULTIQUIP is a registered trademark of Multiquip, Inc.; NU-TEC-SYS is a registered trademark of Nu-Tecsys, Inc.; PANASONIC is a registered trademark of Matsushita Electric Industrial Co., Ltd.; P-TRON is a registered trademark of P-Tron Plasma/Tech Systems; SMITH is a registered trademark of Smith Equipment Co.; INNERLOGIC is a trademark of Innerlogic; none of the above mentioned registered trademarks are in any way affiliated with Thermal Dynamics or Thermadyne Industries, Inc.; THERMAL DYNAMICS, PAK, CUTMASTER, PakMaster, EconoPAK, Dynapak and Drag-Gun are registered trademarks of Thermal Dynamics Corp.

**Ordering Information**

**Spare Parts Selection**

| Description                        | Cat. No. |   |        |  |  |  |
|------------------------------------|----------|---|--------|--|--|--|
| <b>1Torch® Consumables / Parts</b> |          |   |        |  |  |  |
| O-Ring                             | 8-3487   | <p><b>SL60® / SL100®<br/>1Torch Parts</b></p> <p>Patented <b>SURELOK®</b><br/>U.S. Patent 6,163,008<br/>Other Patents Pending</p> <p>8-3487 O-Ring</p> <p>8-3486 O-Ring</p> <p>Electrode</p> <p>Start Cartridge</p> <p>Tip, Drag</p> <p>Tip, Cutting</p> <p>Tip, Gouging</p> <p>Shield Cup</p> <p>MaximumLife® Shield Cup Body</p> <p>Shield Cup</p> <p>Drag Shield Cap</p> <p>Deflector Shield Cap</p> <p>Gouging Shield Cap</p> |        |  |  |  |
| O-Ring                             | 8-3486   |   |        |  |  |  |
| Electrode, MaximumLife®            | 9-8215   |   |        |  |  |  |
| Start Cartridge                    | 9-8213   |   |        |  |  |  |
| Tip, 20A, Drag                     | 9-8205   |   |        |  |  |  |
| Tip, 30A, Drag                     | 9-8206   |   |        |  |  |  |
| Tip, 40A, Drag                     | 9-8207   |   |        |  |  |  |
| Tip, 40A, Cutting                  | 9-8208   |   |        |  |  |  |
| Tip, 50/55A, Cutting               | 9-8209   |   |        |  |  |  |
| Tip, 60A, Cutting                  | 9-8210   |   |        |  |  |  |
| Tip, 70A, Cutting                  | 9-8231   |   |        |  |  |  |
| Tip, 80A, Cutting                  | 9-8211   |   |        |  |  |  |
| Tip, 90/100A, Cutting              | 9-8212   |   |        |  |  |  |
| Tip, A, Gouging                    | 9-8225   |   |        |  |  |  |
| Tip, B, Gouging                    | 9-8226   |   |        |  |  |  |
| Tip, C, Gouging                    | 9-8227   |   |        |  |  |  |
| Tip, D, Gouging                    | 9-8228   |   |        |  |  |  |
| Shield Cup                         | 9-8218   | Spare Parts Kit, 30 Amp   | 5-2550 |  |  |  |
| Shield Cup Body, MaximumLife®      | 9-8237   | Spare Parts Kit, 40 Amp   | 5-2551 |  |  |  |
| Shield Cap, Drag, 40A              | 9-8244   | Spare Parts Kit, 50/55 Amp  | 5-2552 |  |  |  |
| Shield Cap, Drag, 50-60A           | 9-8235   | Spare Parts Kit, 60 Amp   | 5-2553 |  |  |  |
| Shield Cap, Drag, 70-100A          | 9-8236   | Spare Parts Kit, 70 Amp   | 5-2554 |  |  |  |
| Shield Cap, Mach, 40A              | 9-8245   | Spare Parts Kit, 80 Amp   | 5-2555 |  |  |  |
| Shield Cap, Mach, 50-60A           | 9-8238   | Spare Parts Kit, 90/100 Amp   | 5-2556 |  |  |  |
| Shield Cap, Mach, 70-100A          | 9-8239   |   |        |  |  |  |
| Shield Cap, Deflector              | 9-8243   |   |        |  |  |  |
| Shield Cap, Gouging                | 9-8241   |   |        |  |  |  |

(Note: All Spare Parts Kits include ten (10) Tips, five (5) Electrodes and one (1) Start Cartridge.)  
 ■ Standard for all RPT® Torches    ▲ Standard on SL60 RPT Torches    ● Standard on SL100 RPT Torches

| Product Description | Catalog No. | Product Description | Catalog No. | Product Description | Catalog No. |
|---------------------|-------------|---------------------|-------------|---------------------|-------------|
|---------------------|-------------|---------------------|-------------|---------------------|-------------|

**Accessories**

Single Stage Air Filter 7-7507

Leather Leads Cover

20 ft. (6.1m) 9-1260

25 ft. (7.6m) 9-1270

50 ft. (15.2m) 9-1280

**Cutting Guide Kits**

Circle Guide Kit 7-3291

Remote Pendant Control, 20 ft. (6.1m) 7-3460

For use with Machine Torch

Straight Line Cutting Guide 7-8911

Roller/Radius Kit 7-7501

Deluxe Kit 7-8910

1TORCH, ATC, RPT, SL60 and SL100, trademarks of Thermal Dynamics Corporation, are registered with the U.S. Patent and Trademark Office, and are the subject of trademark registrations and pending applications in numerous other countries. For information on trademark registrations of Thermal Dynamics Corporation, contact the local trademark offices in the countries of interest.

**U.S. Plasma Manual Customer Care: 800-752-7621 / FAX 800-221-4401 • International Customer Care: 905-827-9777 / FAX 905-827-9797**  
**U.S. Plasma Automation Customer Care: 866-279-2628 / FAX 316-941-4491 • www.thermal-dynamics.com**



**A Global Cutting & Welding Market Leader™**

**WORLD HEADQUARTERS: 16052 Swingley Ridge Road, Suite 300 • St. Louis, Missouri 63017 U.S.A.**

**THE AMERICAS**

Denton, TX USA  
U.S. Customer Care  
Ph: (1) 800-752-7621  
Fax: (1) 800-221-4401

West Lebanon, NH USA  
Customer Care, Plasma  
Ph: (1) 800-752-7621  
Fax: (1) 800-221-4401

Miami, FL USA  
Sales Office, Latin America  
Ph: (1) 954-727-8371  
Fax: (1) 954-727-8376

Oakville, Ontario, Canada  
International Customer Care  
Ph: (1) 905-827-9777  
Fax: (1) 905-827-9797

Rio de Janeiro, Brazil  
Customer Care  
Ph: (55) 21-2485-8998  
Fax: (55) 21-2485-8866

**EUROPE**

Chorley, United Kingdom  
Customer Care  
Ph: (44) 1257-261755  
Fax: (44) 1257-224800

Milan, Italy  
Sales Office  
Ph: (39) 02-98-80320  
Fax: (39) 02-98-281773

**ASIA/PACIFIC**

Cikarang, Indonesia  
Customer Care  
Ph: 62 21+ 8983-0011 / 0012  
Fax: 62 21+ 893-6067

Osaka, Japan  
Sales Office  
Ph: 816-4809-8411  
Fax: 816-4809-8412

Melbourne, Australia  
Customer Care:  
Ph: 1300-654-674  
Fax: 613- 9474-7391

International:  
Ph: 613+ 9474-7508  
Fax: 613+ 9474-7488

Rawang, Malaysia  
Customer Care  
Ph: 603+ 6092-2988  
Fax: 603+ 6092-1085

Shanghai, China  
Sales Office  
Ph: 86 21+ 6280-1273  
Fax: 86 21+ 3226-0955

Singapore  
Sales Office  
Ph: 65+ 6832-8066  
Fax: 65+ 6763-5812